

First Floor

- 28 – Coffee Bar (1203)
- 29 – Multicultural Involvement & Community Advocacy (1120)
- 30 – Adele’s (1240)
- 31 – Graduate Student Suite (1121)
- 32 – Event Services/Marketing
- 33 – North Court (1482)
- 34 – Undergraduate/Graduate Legal Aid (1235)
- 35 – Nanticoke Room (1238)
- 36 – Marketing Asst. (1236)
- 37 – Stamp Gallery (1220)
- 38 – Atrium (1107)
- 39 – Off Campus Housing (1110)
- 40 – Information Desk (1201)
- 41 – Prince George’s Room (1210)
- 42 – Grand Ballroom Lounge (1209)
- 43 – Grand Ballroom (1206)
- 44 – Reading Room (1105)
- 45 – Office of Fraternity & Sorority Life (1110)
- R – Restrooms
- E – Elevator

FIRST FL

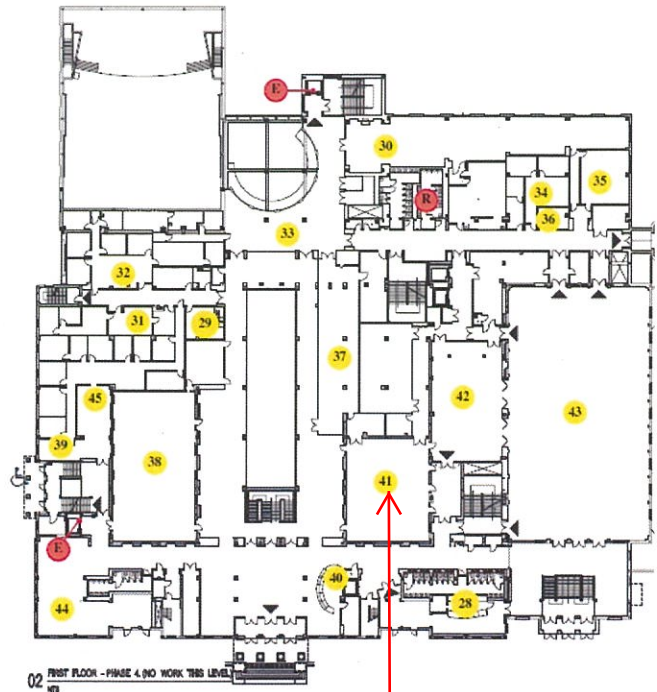

**Breakfast/Awards
Ceremony**

Where we are located ■

Adele Stamp Student Union building is on the right of the intersection between Campus Drive and Union Lane.

Directions to Campus by Car ■

From Baltimore and Points North, via I-95 South

Recommended:

1. Take I-95 South to the Capital Beltway East (I-495)
2. I-95 South will merge to the left, joining I-495
3. Take Exit 23 "201 Kenilworth Avenue Bladensburg Greenbelt"
4. Proceed south on 201 in the direction of "Greenbelt Road and Bladensburg"
5. At second light, turn right onto Paint Branch Parkway
6. Proceed approximately two miles to U.S. Route 1
7. Go straight across Route 1 onto Campus Drive. Continue straight around the circle "M" and travel up the hill.
8. Pass the Hornbake Library and the Psychology Department on your right
9. Stamp Student Union will be on your right.

Alternate:

1. Take I-95 south to the Capital Beltway (I-495)
2. Take exit 27 and then follow signs to Exit 25, "U.S. 1 South, College Park"
3. Proceed approximately two miles on U.S. Route 1 South
4. Turn right onto Campus Drive. Continue straight around the circle "M" and travel up the hill.
5. Pass the Hornbake Library and the Psychology Department on your right
6. Stamp Student Union will be on your right.

From Baltimore and Points North, or Washington DC and points South, Via 295 (the Baltimore/Washington Parkway):

1. Take 295 to its Northern intersection with the Capital Beltway (I-95/I-495)
2. Exit at I-95 / I-495 North
3. Stay in right lane
4. Take Exit 23 "201 Kenilworth Avenue Bladensburg Greenbelt"
5. Proceed South on 201 in the direction of "Greenbelt Road and Bladensburg"
6. At 3rd light, turn right onto Paint Branch Parkway
7. Proceed approximately two miles to U.S. Route 1
8. Go straight across Route 1 onto Campus Drive. Continue straight around the circle "M" and travel up the hill.
9. Pass the Hornbake Library and the Psychology Department on your right
10. Stamp Student Union will be on your right.

From Virginia and Points South, Via Maryland Side of Capital Beltway (I-495)

Recommended:

1. Take I-95 North to the Capital Beltway (I-495)
2. Follow I-95/I-495 North toward Baltimore
3. Take Exit 23 "201 Kenilworth Avenue Bladensburg Greenbelt"
4. Proceed South on 201 in the direction of "Greenbelt Road and Bladensburg"

5. At 3rd light, turn right onto Paint Branch Parkway
6. Proceed approximately two miles to U.S. Route 1
7. Go straight across Route 1 onto Campus Drive. Continue straight around the circle "M" and travel up the hill.
8. Pass the Hornbake Library and the Psychology Department on your right
9. Stamp Student Union will be on your right.

Alternate:

1. Take I-95 North to the Capital Beltway (I-495)
2. Follow I-95/I-495 North toward Baltimore
3. Take exit 25, "U.S. 1 South, College Park"
4. Proceed approximately two miles on U.S. Route 1 South
5. Turn right onto Campus Drive. Continue straight around the circle "M" and travel up the hill.
6. Pass the Hornbake Library and the Psychology Department on your right.
7. Stamp Student Union will be on your right.

From Virginia and Points South, Via Virginia Side of Capital Beltway (I-495)

Recommended:

1. Take I-66 East or I-270 South to Capital Beltway (I-495)
2. Go East on I-495 toward "Baltimore"
3. Take Exit 28B "650 South New Hampshire Avenue Tacoma Park"
4. Go South on New Hampshire Avenue, approximately 1/2 mile
5. At the second traffic light, turn left onto Adelphi Road
6. At the third traffic light, turn left onto University Boulevard (Route 193)
7. Turn right onto U.S. Route 1 South to College Park.
8. Turn right onto Campus Drive. Continue straight around the circle "M" and travel up the hill.
9. Pass the Hornbake Library and the Psychology Department on your right
10. Stamp Student Union will be on your right.

Alternate:

1. Take I-66 East or I-270 South to Capital Beltway (I-495)
2. Go East on I-495 toward "Baltimore"
3. Take Exit 25, "U.S. 1 South, College Park"
4. Proceed approximately two miles on U.S. Route 1 South
5. Turn right onto Campus Drive. Continue straight around the circle "M" and travel up the hill.
6. Pass the Hornbake Library and the Psychology Department on your right
7. Stamp Student Union will be on your right.

From Bowie, Annapolis, and Points East, Via U.S. 50 West

Recommended:

1. Take U.S. 50 West to the Capital Beltway (I-495)
2. Go North on I-95/I-495 toward Baltimore
3. Take Exit 23 "201 Kenilworth Avenue Bladensburg Greenbelt"
4. Proceed South on 201 in the direction of "Greenbelt Road and Bladensburg"
5. At 3rd light, turn right onto Paint Branch Parkway
6. Proceed approximately two miles to U.S. Route 1
7. Go straight across Route 1 onto Campus Drive. Continue straight around the circle "M" and travel up the hill.
8. Pass the Hornbake Library and the Psychology Department on your right
9. Stamp Student Union will be on your right.

Alternate:

1. Take U.S. 50 West to the Capital Beltway (I-495)
2. Go North on I-95/I-495 toward Baltimore. Take Exit 25, "U.S. 1 South, College Park"
3. Proceed approximately two miles on U.S. 1 South
4. Follow signs to turn right into Visitor Center parking area.
5. Turn right onto Campus Drive. Continue straight around the circle "M" and travel up the hill.
6. Pass the Hornbake Library and the Psychology Department on your right. Stamp Student Union will be on your right.

From Washington, D.C. (Northwest/Southwest) Via 16th Street North

1. Take 16th St. North 16th St. becomes Georgia Ave. North at Maryland/D.C. line
2. Go East on the Capital Beltway (I-495) toward "Baltimore"
3. Take Exit 28B "650 South New Hampshire Avenue Tacoma Park"
4. Go South on New Hampshire Avenue
5. Proceed approximately 1/2 mile
6. At the second traffic light, turn left onto Adelphi Road
7. At the third traffic light, turn left onto University Boulevard (Route 193)
8. Proceed through two traffic lights and exit right onto U.S. Route 1 South to College Park
9. Turn right onto Campus Drive. Continue straight around the circle "M" and travel up the hill.
10. Pass the Hornbake Library and the Psychology Department on your right
11. Stamp Student Union will be on your right.

From Washington, D.C. (Northeast/Southeast), Via U.S. 1 North

1. Take Rhode Island Ave. (U.S. 1 North)
2. Rhode Island Ave. (U.S. 1 North) becomes Baltimore Ave. North at the Maryland/D.C. line
3. Proceed through the city of College Park
4. Continue on US Route 1 for approximately five miles and travel through the city of College Park.
5. Turn left onto Campus Drive. Continue straight around the circle "M" and travel up the hill.
6. Pass the Hornbake Library and the Psychology Department on your right
7. Stamp Student Union will be on your right.